

# SerieR

V16/18  
V22  
V25  
V30

F22  
F28

R32  
R40  
R45

TCS  
DIGIT  
AUTOMAX

# VFRHT

S E R I E



**R32**  
**R32E**  
**R40**  
**R40E**  
**R45**  
**R45E**



**SERRMAC**  
INTERNATIONAL S R L

# R32

## Medium-size drilling machine with high performance transmission



Automatic mechanical  
quill-feed



TR: 600 x 345 mm  
Rectangular table with rack



PG: 325 x 325 mm  
Tilting table with rack



PGM: 325 x 325 mm  
Tilting table with vice and rack



**VARIABLE**

**SERRMAC**  
INTERNATIONAL S.R.L.

CE   
MADE IN ITALY

TR

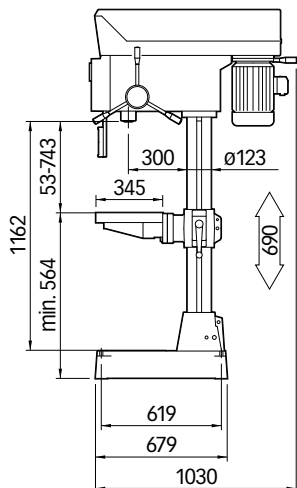

PG

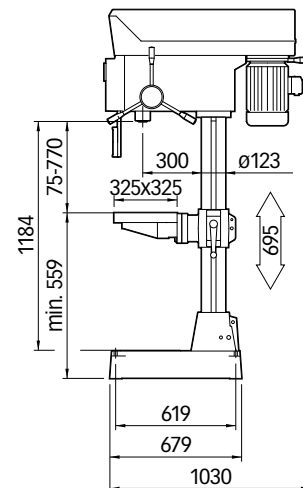

PGM

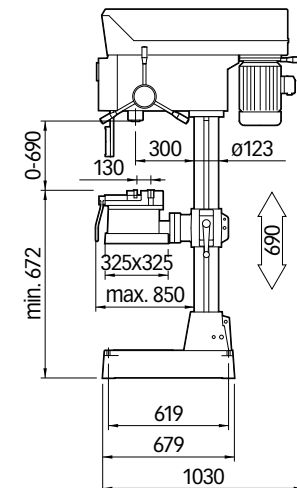

# R32E

## Medium-size drilling machine with high performance transmission and electronic potentiometer

Inverter

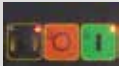

Automatic mechanical  
quill-feed



TR: 600 x 345 mm  
Rectangular table with rack

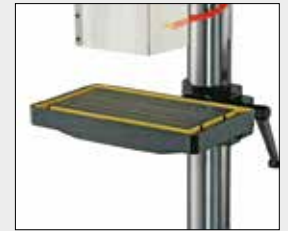

PG: 325 x 325 mm  
Tilting table with rack



PGM: 325 x 325 mm  
Tilting table with vice and rack



VARIABLE

**SERRMAC**  
INTERNATIONAL S.R.L.



TR

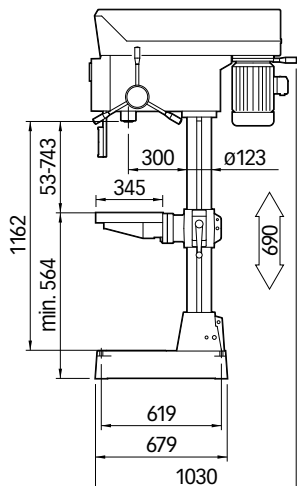

PG

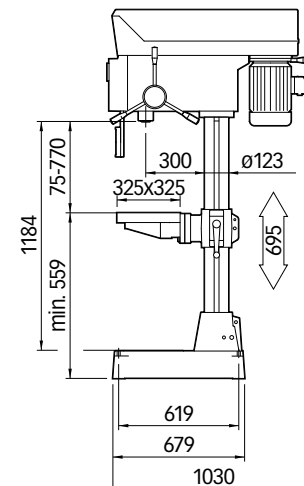

PGM

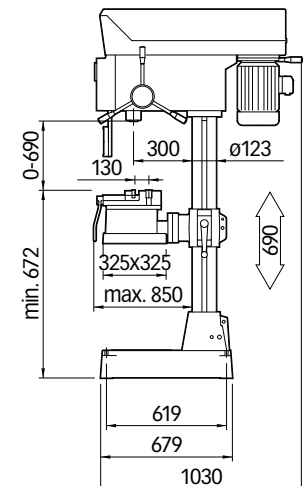

# R40

## Medium/Heavy-size drilling machine with high performance transmission

Threaded quill nose for toll fitting MT4

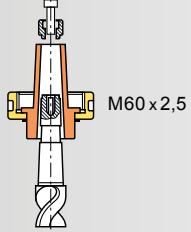
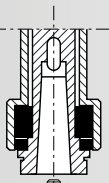

TR: 600 x 345 mm  
Rectangular table with rack

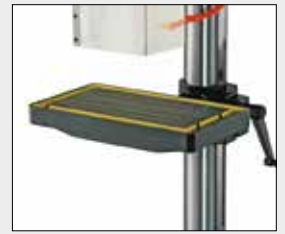

PG: 325 x 325 mm  
Tilting table with rack



PGM: 325 x 325 mm  
Tilting table with vice and rack



TC: 630 x 255 mm  
Cross table



VARABLE

**SERRMAC**  
INTERNATIONAL S.R.L.



TR

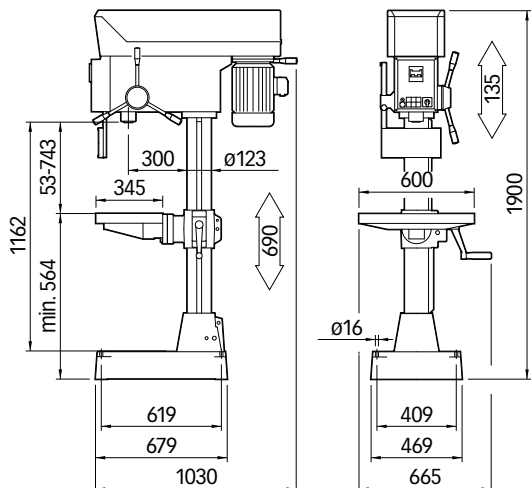

PGM

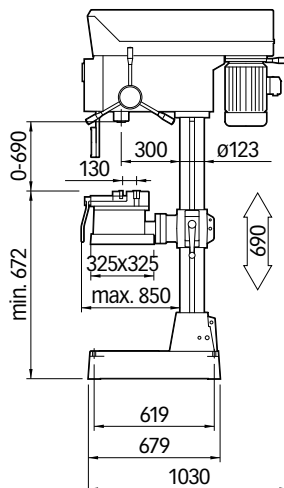

TC

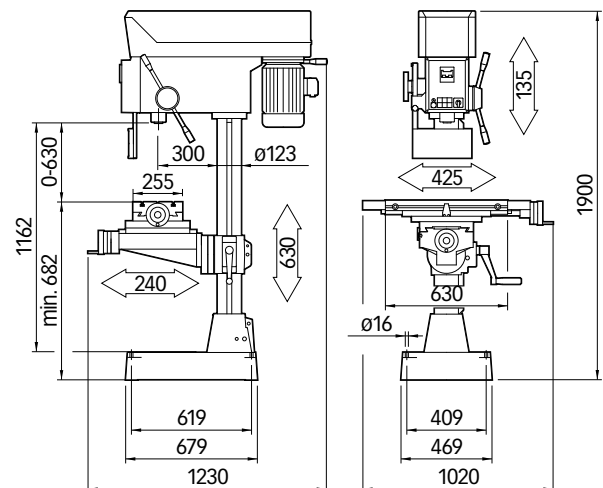

# R40E

Medium/ Heavy-size drilling machine  
with high performance transmission  
and electronic potentiometer

Inverter Easy to set  
Inverter



Threaded quill nose  
for toll fitting MT4

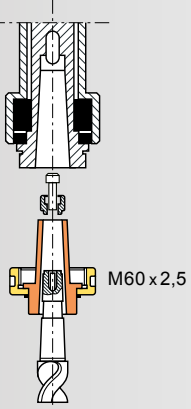

TR: 600 x 345 mm  
Rectangular table with rack

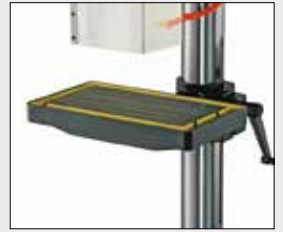

PG: 325 x 325 mm  
Tilting table with rack



PGM: 325 x 325 mm  
Tilting table with vice and rack



TC: 630 x 255 mm  
Cross table



VARIABLE

**SERRMAC**  
INTERNATIONAL S.R.L.

CE   
MADE IN ITALY

TR

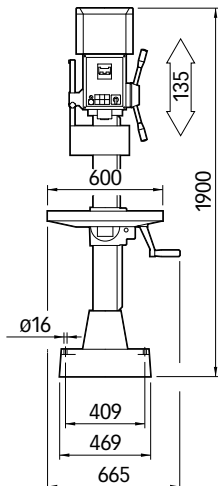
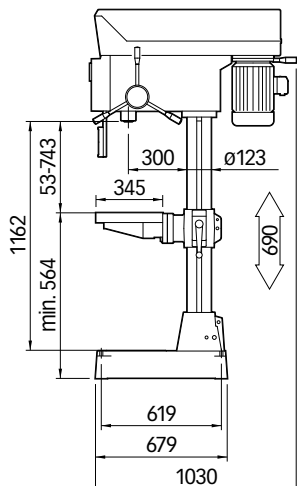

PGM

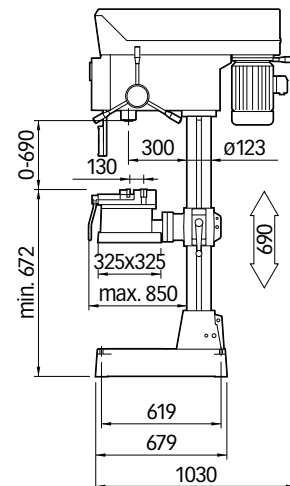

TC

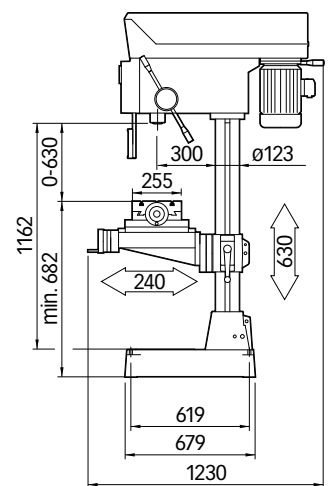
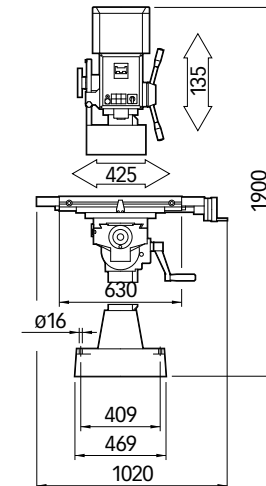

# R45

## Heavy-size drilling machines

Threaded quill nose  
for toll fitting MT4

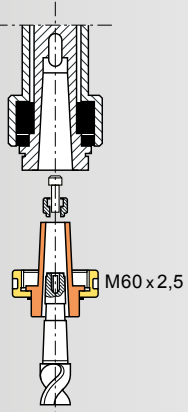

**Standard:** Automatic  
mechanical quill-feed



**TR:** 600 x 460 mm  
Rectangular table with rack



**PGM:** 375 x 375 mm  
Tilting table with vice and rack



**TC:** 630 x 255 mm  
Cross table



**VARIABLE**

**SERRMAC**  
INTERNATIONAL SRL

CE  MADE IN ITALY

TR

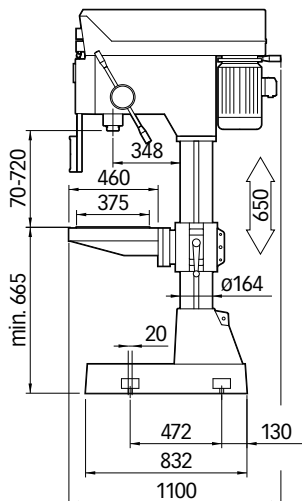

PGM

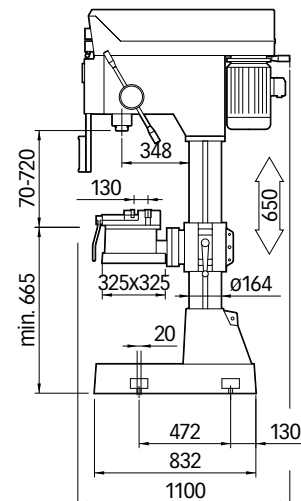

TC

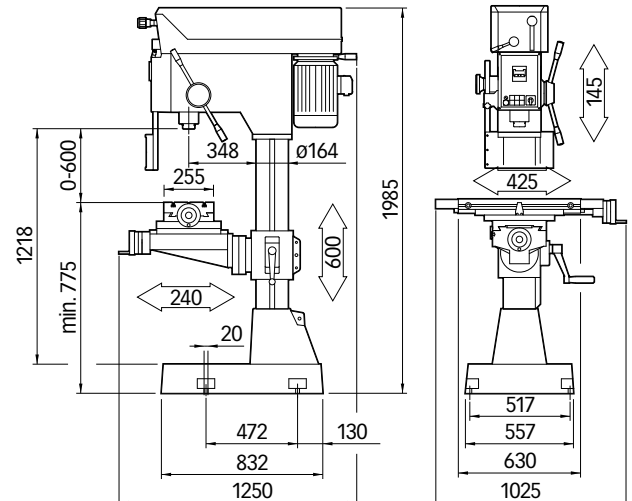

OPTIONS



**Code 40022:** 24 V Halogen light



**Code 30001:** Cooling system



**Code 40002:** Thread-cutting unit with 24 Volt transformer



**Code 40024:** Digital speed counter



**Code 30018:** Flow drill (UR80 hydro-pneumatic quill-feed, digital speed counter, 2.2 -3kW motor) - only with VS

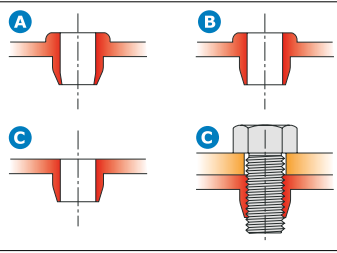
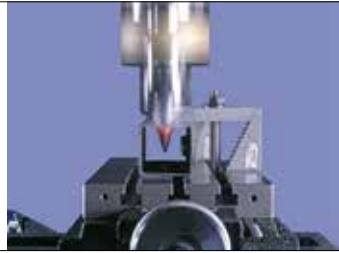

**Code 30003:** Automatic mechanical quill-feed. 3 speeds: 0,05 – 0,1 – 0,2 mm/rot. ( R32 R – 32 R40)

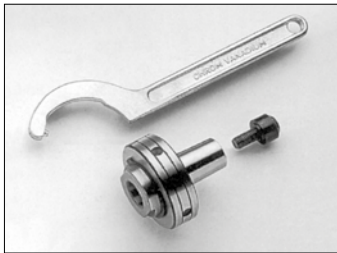

**Code 39000050/60/70:** Adaptor with locking ring nut for mills MT1 - MT2 - MT3 upon request

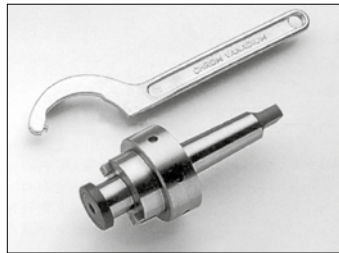

**Code 39000010/20/30/40:** Adaptor with locking ring nut for face-mills attachments on request  $\phi$  16–22–27–32.



**Code 9460009:** Box with MT4 collet-chuck and  $\phi$  4–6–8–10–12–16–20 collets.



**Code 30019:** UR80 Hydro-pneumatic quill-feed ( R32 – R 32 R40)

**Code 40010:** Discesa mandrino idropneumatica UR100 Hydro-pneumatic quill-feed (R45). 105 mm automatic spindle quill-feed with adjustable rapid release feeds. 5÷2.500 mm/min automatic feed. 6 bar-400 Kg thrust power.

## R45

OPTIONS



**Code 40083:** 24 V Dc Electro-magnetic automatic quill-feed



**Code 40025:** Read-out system for X and Y axis (together with TC).



**Code 40026 Power:** Power Mechanical longitudinal cross-table feed



**Code 40006:** Rapid vertical table feed



**Code 40001:** 230 mm long sleeve (only with VS).

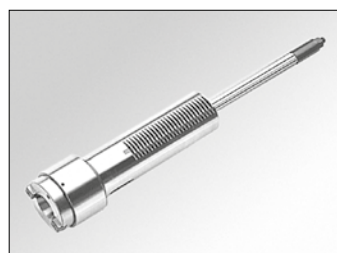

**Code 40020:** ISO 40 spindle including tie-rod .



**Code 40037:** MT4 Drilled spindle axis for tie rod.

# SerieR

		R32		R32E	R40				R40E	R45			R45E	
TECHNICAL DATA	Drilling capacity on R50 steel	mm	ø 32		ø 32	ø 40				ø 40	ø 45			ø 45
	Tapping capacity on R50 steel	mm	M 20		M 20	M 24				M 24	M 26			M 26
	Spindle-intake		MT3		MT3	MT4				MT4	MT4			MT4
	Quill-stroke	mm	135		135	135				135	145			145
	Spindle-quill diameter	mm	62		62	62				62	72			72
	Automatic mechanical quill – feed (option)		3 speeds: 0.05 – 0.1 – 0.2 rpm.											
	Electro-magnetic automatic quill feed		–		–	–				–	3 speeds: 0.05 – 0.1 – 0.2 rpm			--
	Column diameter	mm	123		123	123				123	164			164
	Table		PG – PGM – TR		PG – PGM – TR	PG – PGM – TR – TC				PG – PGM – TR – TC	PGM – TR – TC			PGM – TR – TC
	Transmission		PU	VS	Electronic potentiometer	PU	VS	VR	CI	Electronic potentiometer	VS	VR*	CI* N° 12 Pos.	Electronic potentiometer
	Spindle speed	rpm	100 – 2.200	100 – 1.640	100 – 2.000	100 – 2.200	100 – 1.640	*64 – 2.380	64 – 1.720	45 – 900 / 110 - 2150	100 – 1.650	64 – 2.380	50 – 1.300	45 – 900 / 110 - 2150
	Motor Power (380 V 50 Hz)	kW	1.1 – 1.84		2.2	1.1 – 1.84	1.1 – 1.84	2.2	1.1 – 1.84	2.2	2.2 – 3	2.2	2.2 – 3	3
	T-slots interaxis (between 2 T-slots)	mm	125		125	125				125	200 (TR) – 160 (TM)			200 (TR) – 160 (TM)
	T-slots dimension width	mm	14		14	14				14	14			14
Cross table longitudinal stroke- X axis (manual feed)	mm	–		–	425				425	425			425	
Cross table longitudinal stroke- X axis (automatic feed)	mm	–		–	365				365	365			365	
Cross table transversal stroke- y axis (manual feed)	mm	–		–	240				240	240			240	
Column model dimensions (h x l x d)	mm	1.900 x 665 x 1.030		1.900 x 665 x 1.030	1.900 x 665 x 1.030				1.900 x 1.020 x 1.230 (TC)	1.986 x 675 x 1.100			1.986 x 675 x 1.100	
Weight	Kg	370		370	410				410	548 (TR) – 610 (TC)			548(TR) - 610(TC)	

\* R40 VR option: motor 1.1/1.84 kW - 32/2.380 rpm \* R45 VR option: motor 2.2/3 kW - 32/2.380 rpm \* R45 CI option: motor 2.2/3 kW - 64/1.720 rpm.

## R32 – R32E – R40-R40E

## R32 – R40 – R45

## R40 – R45

## R40 – R45

TRANSMISSIONS

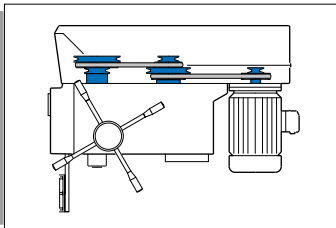

PU: Step pulleys

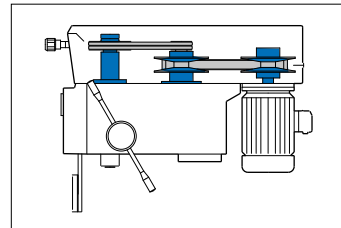

VS: Variable speed-drive unit

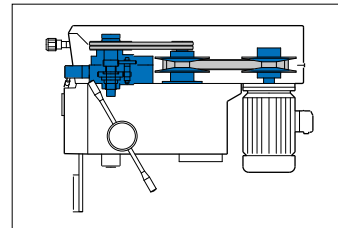

VR: Variable speed-drive unit with gear box

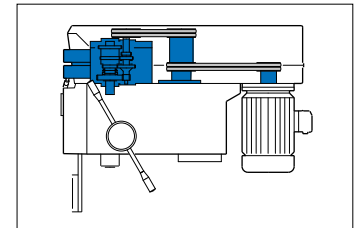

CI: Gear box drive-unit.



VS: Variable speed-drive unit



VR: Variable speed-drive unit with gear box.



CI: Gear box drive-unit



STANDARD: Front panel with Inverter

**SERRMAC**  
INTERNATIONAL S.R.L.

SERRMAC INTERNATIONAL S.r.l.

Via 1° Maggio, 2 - 33070 Budoia (PN) - Italy

Tel. +39 0434 671021

www.serrmac-international.it info@serrmac-international.it



Official dealer